

**Energy Miser® Electric Water Heater
RHEEMGLAS® STANDARD**

- 5-Year limited tank warranty
- 1-Year limited parts warranty

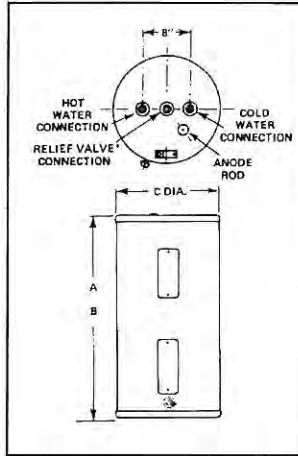

NOTE: Heaters furnished with standard 240 volt AC, single phase non-simultaneous wiring, and 4500 watt upper and lower heating elements.

T Y P E	Model Number	Tank Cap. Gals.	A Height of Heater	B Height to Water Connection	C Jacket Diameter	Approx. Shpg. Wght. Lbs.
T A L L	81V30D	30	45	45	17	84
	81V40D	40	46	46	19	99
T A L L	81V52D	50	56 1/2	56 1/2	19	121
	81V66D	65	58	58	21	154
	81V80D	80	58 1/2	58 1/2	23	182
	81V120D	120	62	62	28 1/2	330
MED	81MV52D	50	45 1/2	45 1/2	21	131
L O W B O Y	81SV30D	30	29	29	21	100
	81SV40D	40	31 1/2	31 1/2	23	128
	81SV50D	47	32	32	26 1/2	158
	81SV52D	50	38 1/2	38 1/2	23	144

**Energy Miser® Electric Water Heater
RHEEMGLAS® STANDARD PLUS**

- 5-Year limited tank warranty
- 1-Year limited parts warranty
- Compliant with many electric utility incentive programs

T Y P E	Model Number	Tank Cap. Gals.	Energy Factor	A Height of Heater	B Height to Water Connection	C Jacket Diameter	Approx. Shpg. Wght. Lbs.
T A L L	82VR52-2	50	0.93	56 1/2	56 1/2	21	127
	82VR66-2	65	0.91	58 1/2	58 1/2	23	170
	82VR80-2	80	0.91	58 1/2	58 1/2	24 1/2	200
MED	82MVR52-2	50	0.93	45 1/2	45 1/2	23	125

**Energy Miser® Electric Water Heater
RHEEMGLAS® IMPERIAL PLUS**

- 10-Year limited tank warranty
- 10-Year limited parts warranty
- Compliant with many electric utility incentive programs

T Y P E	Model Number	Tank Cap. Gals.	Energy Factor	A Height of Heater	B Height to Water Connection	C Jacket Diameter	Approx. Shpg. Wght. Lbs.
T A L L	82XR52-2	50	0.93	56 1/2	56 1/2	21	127
	82XR66-2	65	0.91	58 1/2	58 1/2	23	170
	82XR80-2	80	0.91	58 1/2	58 1/2	24 1/2	200

****NOTICE****

DUE TO THE WIDE RANGE OF SPECIFICATIONS AND MODELS AVAILABLE, WE HAVE NOT SHOWN THE COMMERCIAL WATER HEATERS THAT ARE AVAILABLE. PLEASE CALL OR FAX US WITH YOUR SPECIFICATIONS AND WE WILL QUOTE A WATER HEATER TO FIT YOUR REQUIREMENTS.

Energy Miser® Gas Water Heater RHEEMGLAS® FURY

- 5-Year limited tank warranty
- 1-Year limited parts warranty

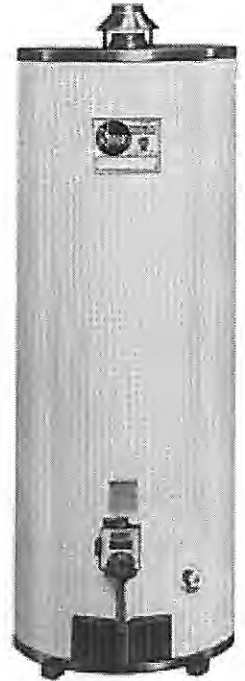

TYPE	Model Number†	Tank Cap. Gals.	Gas Input in Thousands BTU/Hr.		Recovery in G.P.H. 90° Rise		First Hour Delivery Rating G.P.H.		Appx. Shpg. Wght. Lbs.	Roughing in Dimensions (Shown in inches)							Side Relief Valve	Hot/Cold Fillings
			Nat.	LP Burner	Nat.	LP	Nat.	LP		A B C D E F J K								
TALL	21V30-6	30	32	30	32.3	30.3	53	51	97	59	56	15 1/4	13 1/4	3	8	—	3/4	
	21V40-7	40	34	34	34.3	34.3	62	62	116	60	56 1/2	17 1/4	13 1/4	3	8	—	3/4	
	41V50	50	40	40	40.4	40.4	74	74	151	61	57	19 1/4	13 1/4	3	8	—	3/4	
	21V50-6A	50	60	60	60.6	60.6	95	95	180	63 1/2	59 1/2	22 1/2	14 1/4	4	11	53 1/4	1	
	21VR75	75	75.5	69	76.3	69.7	120	116	320	64 1/2	60 1/2	26 1/4	14 1/4	4	11	54 1/2	1	
21V100-1	100	75	69	76.3	69.7	135	133	350	68	64	26 1/4	14 1/4	4	11	58	1		
LOWBOY	21V40S-2	40	28	28	28.3	28.3	55	55	120	50 1/4	47 1/2	19 1/4	13 1/4	3	8	—	3/4	

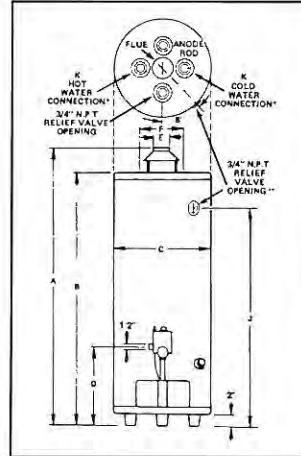

Energy Miser® High Performance, Gas Water Heater RHEEMGLAS® FURY Plus

- 5-Year limited tank warranty
- 1-Year limited parts warranty
- Compliant with many gas utility incentive programs

TYPE	Model Number†	Tank Cap. Gals.	Gas Input in Thousands BTU/Hr.		Recovery in G.P.H. 90° Rise		First Hour Delivery Rating G.P.H.	Energy Factor	Appx. Shpg. Wght. Lbs.	Roughing in Dimensions (Shown in inches)								
			Nat.	LP Burner	Nat.	LP				A B C D E F G H								
TALL	41VR40	40	40	40	40.4	40.4	68	68	0.62	127	61 1/4	58 1/2	21	8	3	13 1/4	2	1/2
	41VR50	50	40	40	40.4	40.4	74	74	0.62	151	60 3/4	57 1/2	23	8	3	13 1/4	2	1/2

Energy Miser® Gas Water Heater RHEEMGLAS® IMPERIAL

- 10-Year limited tank warranty
- 1-Year limited parts warranty

TYPE	Model Number†	Tank Cap. Gals.	Gas Input in Thousands BTU/Hr.		Recovery in G.P.H. 90° Rise		First Hour Delivery Rating G.P.H.	Appx. Shpg. Wght. Lbs.	Roughing in Dimensions (Shown in inches)							Side Relief Valve	Hot/Cold Fillings
			Nat.	LP Burner	Nat.	LP			A B C D E F J K								
TALL	21X40-7	40	34	34	34.3	34.3	62	62	116	60	56 1/2	17 1/4	13 1/4	3	8	—	3/4
	41X50	50	40	40	40.4	40.4	74	74	151	61	57	19 1/4	13 1/4	3	8	—	3/4

HOT WATER DISPENSERS AND WATER HEATERS

HOT-1

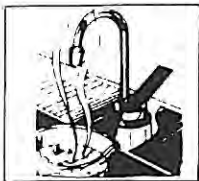

C1960

Household model

- Capacity - up to 40 cups of 190° water per hour
- 500 watts, 4.3 amps, 115 volts A.C.

H-770

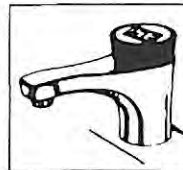

C1961

Household model

- Capacity - up to 60 cups of 190° water per hour
- 750 watts, 6.5 amps, 115 volts A.C.

ULTRA SYSTEMS UW

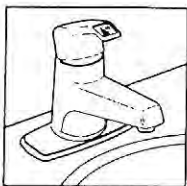

C1962

- Available in chrome
- Warm and cold water instantly from a single cold water line.
- 1300 watts, 11.1 amps, 115 V.
- 10.8 gallons warm water per hour.

ULTRA SYSTEMS PLUS UH

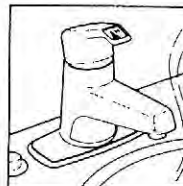

C1965

- Available in chrome
- 190° hot, warm and cold water instantly from a single cold water line.
- 1300 watts, 11.1 amps, 115 volts

H-990, H-990W "EURO"

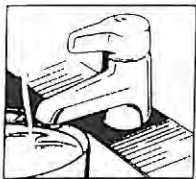

C6891 - White

C6890 - Chrome

- White or chrome finish, European styling - twist lever handle
- Capacity - up to 60 cups of 190° water per hour
- 750 watts, 6.5 amps, 115 volts A.C.

W-152



C1963

2-1/2" Gal.

- Bronze, long-life storage tank
- Replaceable copper heating element
- Adjustable temperature 110°-170°F

W-154

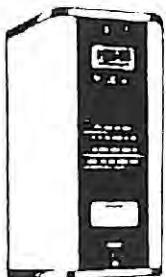

C1964

4 Gal.

- Bronze, long-life storage tank
- Replaceable copper heating element
- Adjustable temperature 110°-170°F





C2996 DET Expansion Tank

SERIES DET Watts Series DET expansion tanks are designed to absorb the increased volume of water created when the hot water storage tank is heated and keeps the system pressure below the relief setting of the T&P relief valve. It is a pre-pressurized steel tank with an expansion membrane that prevents contact of the water with the air in the tank.



The answer to thermal expansion problems

C2997 "Watts® Governor 80" Ball Cock Relief Valve

A triple purpose product: toilet tank ball cock fill valve, anti-siphon backflow preventer and thermal expansion relief valve in one assembly. It is listed by IAPMO and CSA certified for anti-siphon ball cocks, FDA approved under CFR-21-177-2600, ANSI/A.S.S.E. No. 1002. It will govern and limit the domestic water system preset static pressure to 80 psi as required by plumbing codes. Eliminates the need for thermal expansion tanks, auxiliary relief valves and their discharge lines.

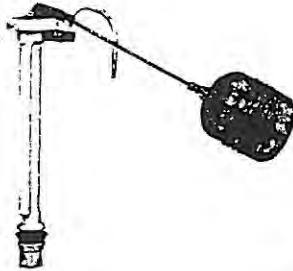

Series 25AUB Bronze Body Water Pressure Regulator

For supply water pressures up to 300 lbs. and can be adjusted from 25 to 75 lbs. The standard setting is 50 lbs. The by-pass feature incorporated into these valves accurately controls build-up of system pressure and thermal expansion by equalizing the system and supply pressure when relief setting is in excess of available supply main pressure. Max. temp. 180°F.

- Renewable stainless steel seat
- Stainless steel integral strainer
- High temperature resisting reinforced diaphragm for hot or cold water

25AUB
with Gauge
Suffix GG

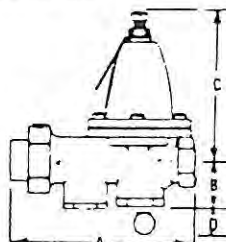

No.	Size (Inches)	Dimensions (Inches)			
		A	B	C	D
25AUB	1/2, 3/4	5-1/2	1-1/4	3-7/8	2-1/2
25AUB	1	6	2	4	2-1/2
25AUB	1-1/4	8-3/4	2-1/4	5-1/2	2-1/2
25AUB	1-1/2	9	2-1/4	5-1/2	2-1/2
25AUB	2	9-1/4	3-1/4	6-3/4	2-1/2

C2944 - 1/2"	C2947 - 1-1/4"
C2945 - 3/4"	C2948 - 1-1/2"
C2946 - 1"	C2949 - 2"

C2939 Series 8 Hose Connection Vacuum Breakers For Back-siphonage Protection

Tested and certified under A.S.S.E. Std. 1011 and CSA Std. B64.2

For residential and industrial hose supply outlets not subject to continuous pressure. Watts Series 8 are brass bodied devices which provide back-siphonage protection for portable hoses connected to hose thread faucets. Prevents the reverse flow of contaminated water back into the potable water supply. Suitable for either inside or outside use. Max. pressure 125 psi.

Inlet: 3/4" std. female hose thread
Outlet: 3/4" std. male hose thread

No. 8C - No. 8 with chrome finish. **C2943**
No. 8A - Same as No. 8 except with **C2940** exclusive patented "non-removable" feature. Prevents unauthorized removal from sill cock or hose hydrant.
No. 8AC - No. 8A with chrome finish. **C2941**



No. 8

Pat. No. 3,171,423



No. 8A

Pat. No. 3,459,443 3,171,423

Series 288A Anti-Siphon Vacuum Breakers For Hot or Cold Water

For high hazard cross connections not subject to continuous pressure - 6" above flood rim.

Series 288A vacuum breakers are designed to prevent back-siphonage of contaminated water into a potable water supply.

Sizes 1/4" to 1" are available in either plain brass or polished chrome finish.

Sizes 1 1/4" to 3" standardly furnished with plain brass finish.

Maximum temperature 210°F at 125 lbs. working pressure.



	BRASS	CHROME
C288A 3/8"	-	C2973
1/2"	C2969	C2974
3/4"	C2970	C2975
1"	C2971	C2976
C2977	Repair Kit for 3/8"	
C2978	Repair Kit for 1/2"	
C2979	Repair Kit for 3/4"	

Series 777S, 77S "Y" Type Strainer For Water and Steam Service

- Tapped Closure (Plug not supplied)
- WSP 250 psi - 400 psi WOG (77S)
- WWP 250 psi @ 210°F and WSP 125 lbs. @ 400°F. (777S)

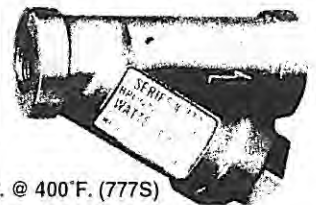

C2954 - 1/2" 77S	C2983 - 1/2" 777S
C2955 - 3/4" 77S	C2984 - 3/4" 777S
Iron Body	Bronze Body

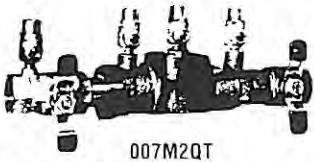

**DOUBLE CHECK VALVE
BACKFLOW
PREVENTERS**

Cat. No.	Model	Size	Body
C6835	007QT	1/2"	Bronze
C2926	007M2QT	3/4"	Bronze
C2927	007M1QT	1"	Bronze
	007M2QT	1-1/4"	Bronze
C2928	007M2QT	1-1/2"	Bronze
C2929	007M1QT	2"	Bronze

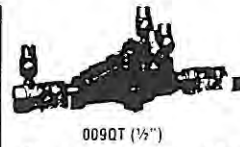

**REDUCED PRESSURE ZONE
BACKFLOW PREVENTERS**
with quarter-turn shut-off valves

Cat. No.	Model	Size	Body
	009QT	1/4"	Bronze
	009QT	3/8"	Bronze
C2930	009QT	1/2"	Bronze
C2931	009M2QT	3/4"	Bronze
C2932	009QT	1"	Bronze
	009M2QT	1-1/4"	Bronze
C2933	009M2QT	1-1/2"	Bronze
	009M2QT	2"	Bronze



**"DUO-CLOZ" WATER
SHUT-OFF VALVES
FOR WASHING MACHINES**

C2935
Model No. 2TM2
Size 1/2"
Brass - 006643
Male Threaded Brass



AIR GAPS

C2986
Model No. 909-AG-A
Size 1/4" - 1/2" 009, 3/4" 009M2
C2987
Model No. 909-AG-C
Size 3/4", 1" 009/909, 1, 1-1/4", 1-1/2" 009M2
C2988
Model No. 909-AG-F
Size 1-1/4" - 2" 009M1, 1-1/4" - 3" 009/909
4" - 6" 990/992/993



**SPECIALTY RELIEF VALVES
POPPET TYPE - PRESSURE
RELIEF VALVES**
C=Calibrated Type

Model No. 530C
Size 1/2" & 3/4"



PRESSURE REGULATOR
Threaded female union inlet x NPT
threaded female outlet

C3002
Model No. N35BU
Size 3/4"
C3003
Model No. N35BU
Size 1"

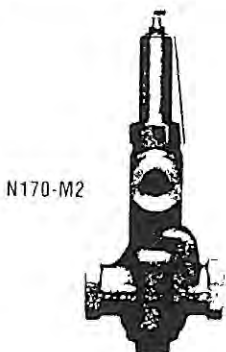

**LOW TEMPERATURE HOT
WATER EXTENDER
TEMPERING VALVES**
100° -130°F
For Commercial Installations

C3004
Model No. N170L-M2
Size 3/4"



934 S.E. Sixth Avenue • Portland, Oregon 97214 • (503) 235-2167 • (800) 929-5039 • Fax (503) 239-3774

Series 40

A.S.M.E. Rated, ANSI Z21.22 "Relief Valves and Automatic Gas Shut-off Devices", Design Certified by A.G.A. and C.G.A. listed. Meets Military Spec. MIL-V-136-12D, Type I.

Temperature relief 210°F. Standard pressure settings 150 lbs.

- Bronze body construction
- Vacuum relief valve vent in drain
- Back-up emergency safety fuse plug
- Tamper-resistant bonnet screws
- Thermostat is accurate and proven, exclusively designed and manufactured by Watts

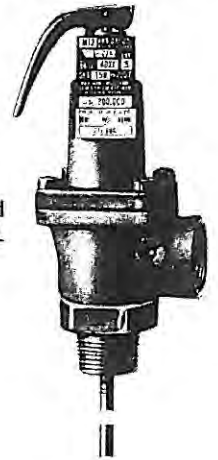

No. 40L Series and No. 40XL Series

CAT NO.	Type No.	Inlet	Outlet	Thermostat Length (Below inlet thread)	DIMENSIONS		Weight Lbs.	A.G.A. - C.G.A. Temp. Steam Rating BTU/HR	A.S.M.E. Pressure Steam Rating BTU/HR	Model
					Height (Less Thermostat)	Width				
C2951	40XL-5	3/4" M	3/4" F	5"	5 5/8"	2 5/8"	1 3/4	200,000	777,600	M12
C2950	40XL-4	1" M	1" F	4"	6 1/4"	2 1/4"	2 1/4	500,000	1,155,000	M12
C2952	40XL-7	1" M	1" F	7"	6 1/4"	2 3/4"	2 1/4	500,000	1,155,000	M12

Series 174A

A.S.M.E. Water Pressure Safety Relief Valves

Bronze body safety relief valves for pressure protection only of all types of hot water heating boiler equipment. Pressure range 30 to 150 lbs. with corresponding high BTU/Hr. ratings from 650,000 to 14,370,000 BTU/Hr. Female inlet and outlet connections. Sizes 3/4" to 2".

Meets Military Spec. MIL-V-136-12D, Type III.



A.S.M.E. Rated and Tested

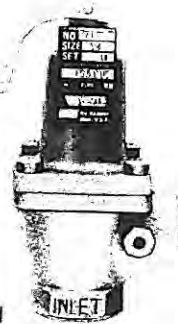

CAT NO.	SIZE	PRESSURE	HEIGHT	MODEL
C2959	3/4"	30 lbs	5 1/8"	m 3
C2960	3/4"	50 lbs	5 1/8"	m 3
C2961	3/4"	100 lbs	5 1/8"	m 3
C2962	3/4"	125 lbs	5 1/8"	m 3
C2963	3/4"	150 lbs	5 1/8"	m 3
C2964	1"	30 lbs	5 3/4"	m 1
C2966	1"	150 lbs	5 3/4"	m 1

Series 70A, L70A

Hot Water Extender Tempering Valves for Residential Installations

For domestic hot water service. Mixes cold water and hot water. For automatic storage water heaters it increases draw capacity.

Convenient adjusting dial for "finger-tip" temperature control. Heavy stainless steel springs. Standard temperature range 120°F - 160°F. Max. temperature 210°F. Max. pressure 150 psi.

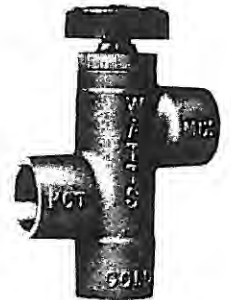

No. L70A - Special model available for temperature range 100°F - 130°F.

- All bronze construction
- Thermostat interchangeable in all sizes



Adjustable Feature

CAT NO.	SIZE	CONNECTIONS	MODEL
C2998	1/2"	Sweat	L70A
C3000	1/2"	Threaded	L70AT
C3001	3/4"	Threaded	L70AT
C2953	1/2"	Threaded	70A

BLUE RIBBON MODEL

No. 100XL Size 3/4" 150 lbs.

A.S.M.E. rated, Self-closing T & P Relief Valves for Water Heaters up to 100,000 BTU/Hr.

A THERMOSTAT WITH THERMO-BONDED (NON-METALLIC) PROTECTIVE COATING and a highly protective dielectric barrier to protect thermostat from accumulations of mineral deposits and galvanic corrosive action. Extends the effective life of the valve by overcoming problems created by adverse water conditions.



Standard length C2956
8" Extended therm C2957



46

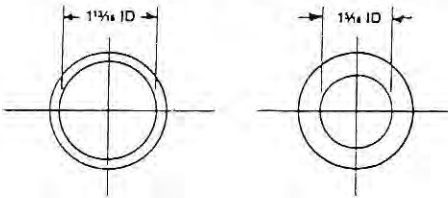

RING GASKETS

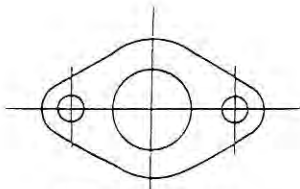

FULL FACE GASKET

24 REPAIR KIT

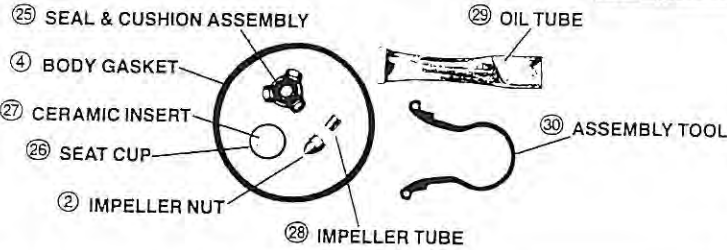

PARTS FOR LITTLE RED BOOSTER PUMPS

ITEM NO.	DESCRIPTION	LR-20 LR-20BF	LR-20B	LR-12 LR-12BF	LR-12B	LR-15B
1	Body	P85637*	P15600	P85637*	P15600	P15600
3	Impeller	P15627	P15627	P15629	P15629	P15627
	Capacitor 115V	M15782	M15782	M15784	M15784	M15784
	Capacitor 110V	M15782	M15782	NONE	NONE	NONE
	Capacitor 220V	M15783	M15783	M15784	M15784	M15784
	Flange Gasket Set - Ring Type - 1 1/4" ID	118368	NONE	118368	NONE	NONE
	Fastener Package For Above	P64910	NONE	P64910	NONE	NONE
	Flange Gasket Set - Ring Type - 1 1/2" ID (2 req'd)	P15692	P15692	P15692	P15692	P15692
	Fastener Package For Above	P15696	P15696	P15696	P15696	P15696
	Flange Gasket Set - Full Face	118071	NONE	118071	NONE	NONE
	Fastener Package For Above	P85639	NONE	P85639	NONE	NONE
24	Repair Kit - Consisting of:	189141	189141	189141	189141	189141
25	Seal & Cushion Assembly	189142	189142	189142	189142	189142
26	Seat Cup	P15683	P15683	P15683	P15683	P15683
27	Ceramic Insert	P15684	P15684	P15684	P15684	P15684
2	Impeller Nut	P15697	P15697	P15697	P15697	P15697
28	Impeller Tube	P15698	P15698	P15698	P15698	P15698
29	Oil Tube	P15775	P15775	P15775	P15775	P15775
4	Body Gasket	P15691	P15691	P15691	P15691	P15691
30	Assembly Tool	P15210	P15210	P15210	P15210	P15210

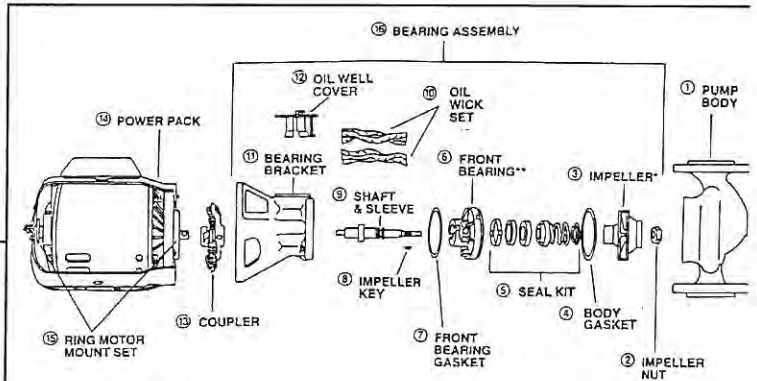

PARTS FOR PD PUMPS

ITEM	DESCRIPTION	PD-35	PD-37	PD-38	PD-39	PD-40
1	BODY (CI)	118449	118449	P08460	P08460	P08460
1	BODY (BRONZE)	P09290	P09290	P08440	P08440	P08440
16	BEARING ASSY (STD)	C5065 (186863)	C5065 (186863)	185260	185260	185260
16	BEARING ASSY (BRONZE)	C5065 (186863)	C5065 (186863)	185262	185262	185262
3	IMPELLER	118630	118629	P08709	118452	118452
3	IMPELLER (BRONZE)	118627	118626	P08689	118453	118453
	FLANGE GASKET SET	118129	118129	118129	118129	118129
4	BODY GASKET	C5081 (P57410)	C5081 (P57410)	P57700	P57700	P57700
10	OIL WICK SET	118395	118395	P04883 (2)	P04883 (2)	P04883 (2)
5	SEAL KIT	C5058 (118681)	C5058 (118681)	186499	186433	186499
14	POWER PACK (1 PH)	111044	111047	111050	111050	169095
14	POWER PACK (3 PH)	111046	111049	169090	169090	169092
15	RING MOTOR MOUNT SET	C5048 (118228)	C5048 (118228)	M71583 (2)	M71583 (2)	M71583 (2)

COUPLER SELECTION TABLE

PUMP SHAFT SIZE	PUMP SERIES	HP	FRAME SIZE	MOTOR SHAFT SIZE	COUPLER NO.
1/2"	PD-35 AND PD-37	1/2-3/4	B&G	1/2"	C5053 (118473)
1/2"	PD-35 AND PD-37	1/2-3/4	56-57-65	5/8"	118709
1/2"	PD-35 AND PD-37	1/2-3/4	66-75	3/4"	118708
5/8"	PD-38 AND PD-39	1	56	5/8"	P71271
5/8"	PD-40	1-1/2-2	56-145TZ	5/8"	P71265

PARTS FOR SERIES 100 BOOSTER PUMPS MADE AFTER NOVEMBER, 1956

ITEM	DESCRIPTION	#75	#100	#125	#150
1	BODY (C.I.)	118339	118339	118339	118339
1	BODY (BRONZE)	118413	118413	118413	118413
	BODY CAPSCREW (4 REQ.)	P40020	P40020	P40020	P40020
2	IMPELLER NUT	P04670	P04670	P04670	P04670
3	IMPELLER (BRONZE)	C5051 (118431)	C5051 (118431)	C5051 (118431)	C5051 (118431)
3	IMPELLER (NFI)	C5074 (189132)	C5074 (189132)	C5074 (189132)	C5074 (189132)
4	BODY GASKET	C5077 (P04080)	C5077 (P04080)	C5077 (P04080)	C5077 (P04080)
5	SEAL KIT	C5058 (118681)	C5058 (118681)	C5058 (118681)	C5058 (118681)
16	BEARING ASSEMBLY (STANDARD)	C5061 (118844)	C5061 (118844)	C5061 (118844)	C5061 (118844)
6	FRONT BEARING (ON 118844)	189070	189070	189070	189070
16	BEARING ASSEMBLY (BRONZE)	C5066 (189034)	C5066 (189034)	C5066 (189034)	C5066 (189034)
6	FRONT BEARING (ON 189034)	189071	189071	189071	189071
7	FRONT BEARING GASKET	P80815	P80815	P80815	P80815
8	IMPELLER KEY	P04940	P04940	P04940	P04940
13	COUPLER ASSY (STAMPED STEEL)	C5071 (189110)	C5071 (189110)	C5071 (189110)	C5071 (189110)
13	COUPLER ASSEMBLY (CAST IRON)	C5059 (118705)	C5059 (118705)	C5059 (118705)	C5059 (118705)
10	OIL WICK SET	118395	118395	118395	118395
9	SHAFT AND SLEEVE	C5067 (189035)	C5067 (189035)	C5067 (189035)	C5067 (189035)
14	POWER PACK	111034	111034	111034	111034
15	RING MOTOR MOUNT SET	C5047 (118223)	C5047 (118223)	C5047 (118223)	C5047 (118223)
	FLANGE GASKET SET	C5049 (118368)	C5049 (118368)	C5049 (118368)	C5049 (118368)



Bell & Gossett

ITT Fluid Technology Corporation

PD Booster Pump

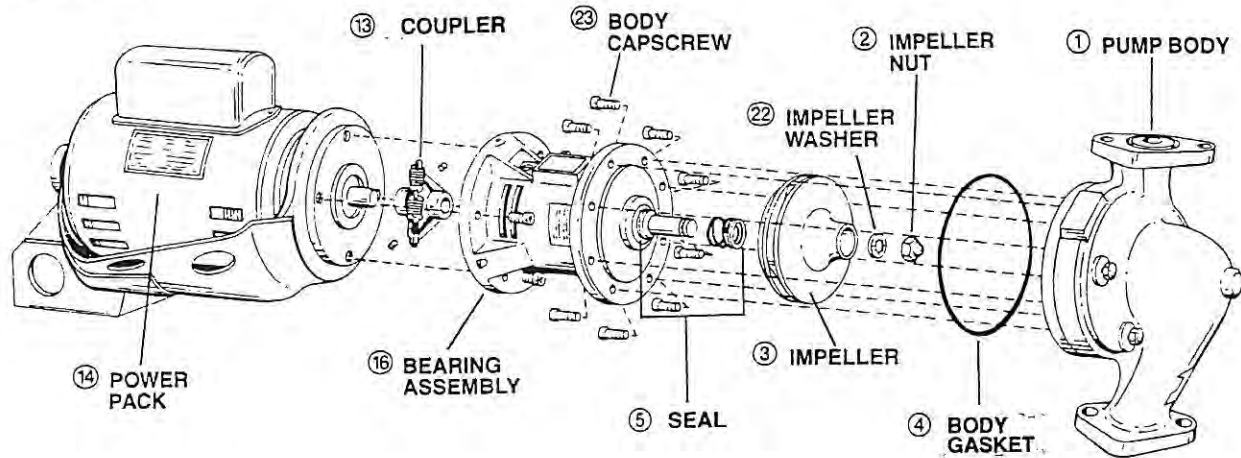

PD Booster Pump Bearing Assembly

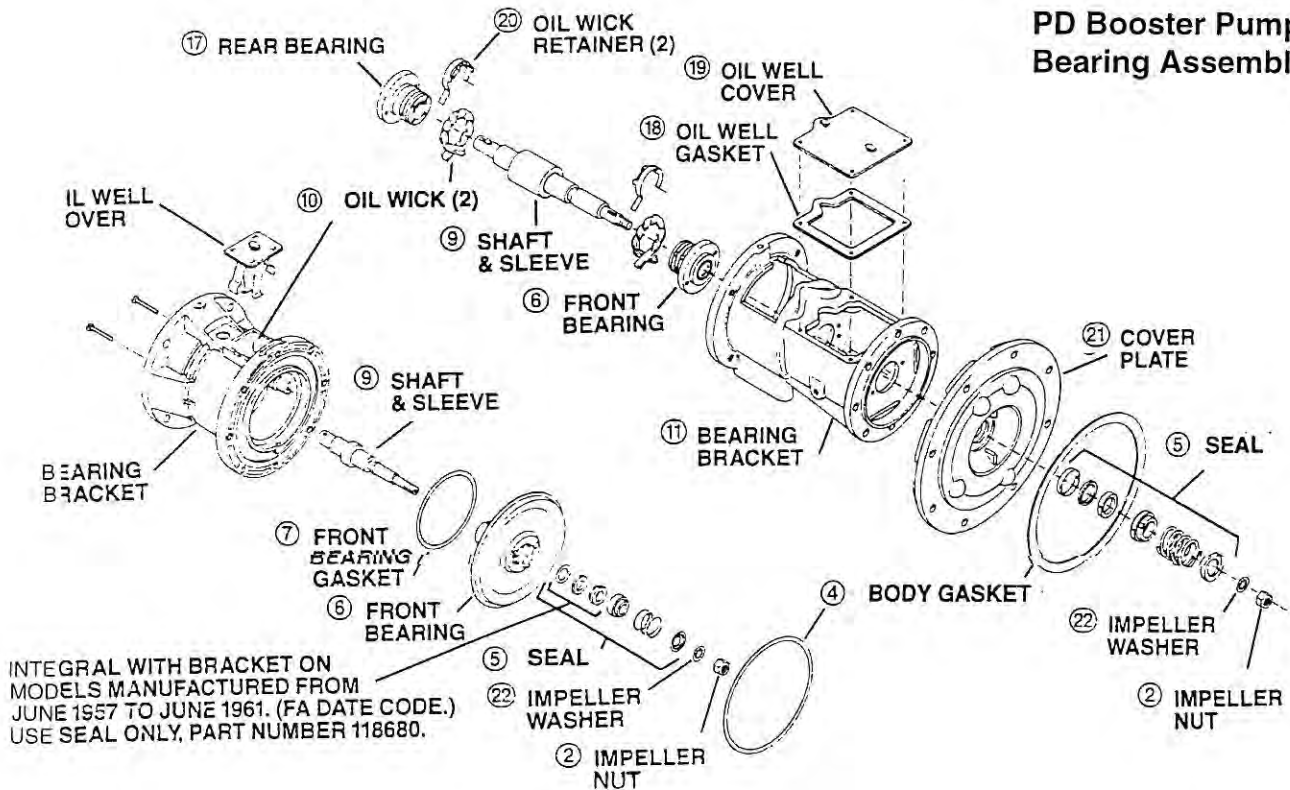

934 S.E. Sixth Avenue • Portland, Oregon 97214 • (503) 235-2167 • (800) 929-5039 • Fax (503) 239-3774

WATER FLEX

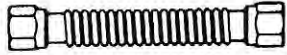

C6956 WRJ 1.020" O.D. x .687"
I.D. x 240" Thick Rubber
Washer. (Old Style) Beveled

C824	12"	7/8" O.D. TUBE	WB00	3/4" F.I.P. x 3/4" F.I.P.
C825	15"	7/8" O.D. TUBE	WB00	3/4" F.I.P. x 3/4" F.I.P.
C826	18"	7/8" O.D. TUBE	WB00	3/4" F.I.P. x 3/4" F.I.P.
C827	24"	7/8" O.D. TUBE	WB00	3/4" F.I.P. x 3/4" F.I.P.
C828	12"	7/8" O.D. TUBE	WB034	3/4" F.I.P. x 3/4" Nom. Male/Female Sweat (7/8" I.D.)
C829	15"	7/8" O.D. TUBE	WB034	3/4" F.I.P. x 3/4" Nom. Male/Female Sweat (7/8" I.D.)
C830	18"	7/8" O.D. TUBE	WB034	3/4" F.I.P. x 3/4" Nom. Male/Female Sweat (7/8" I.D.)
C831	24"	7/8" O.D. TUBE	WB034	3/4" F.I.P. x 3/4" Nom. Male/Female Sweat (7/8" I.D.)

WATER HEATER ELEMENTS

WE STOCK GASKETS FOR ELEMENTS ALSO!

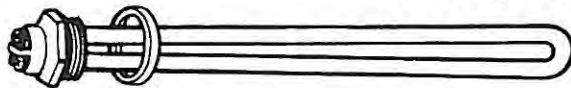

SCREW-IN

C428	1500W	120V
C430	2000W	120V
C431	2500W	240V
C432	3000W	240V
C433	3500W	240V
C435	4500W	240V
C438	4000W	240V-LWD
C439	4500W	240V-LWD
C440	4500W	240V-LIMELIFE
C436	5500W	240V

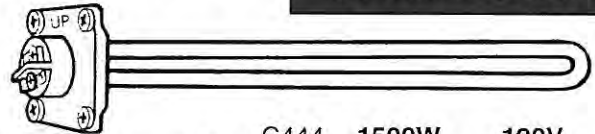

UNIVERSAL FLANGE

C444	1500W	120V
C445	2500W	240V
C446	3000W	240V
C447	3500W	240V
C449	4500W	240V
C452	4500W	240V

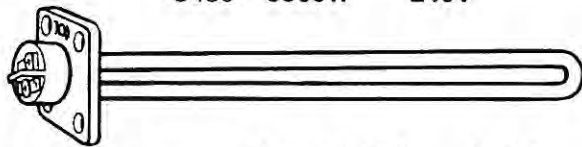

FLAT FLANGE

C442	4500W	240V
C443	4500W	240V

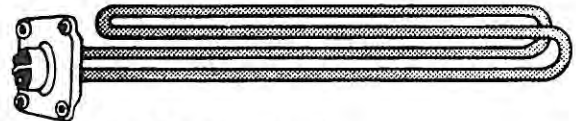

UNIVERSAL FLANGE - LWD

C451	4000W	240V
C453	4500W	240V

LWD = Low Watt Density

GAS FLEX

1/2" I.D.

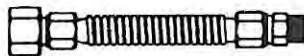



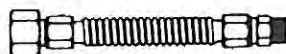







3/8" I.D.

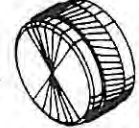

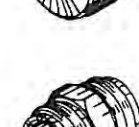



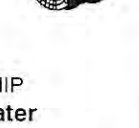





C833	18"	1/2" I.D.	SC21	3/4" F.I.P. x 3/4" M.I.P.
C834	24"	1/2" I.D.	SC21	3/4" F.I.P. x 3/4" M.I.P.
C835	30"	1/2" I.D.	SC21	3/4" F.I.P. x 3/4" M.I.P.
C836	36"	1/2" I.D.	SC21	3/4" F.I.P. x 3/4" M.I.P.
C837	48"	1/2" I.D.	SC21	3/4" F.I.P. x 3/4" M.I.P.
C841	36"	1/2" I.D.	SC54	1/2" F.I.P. x 1/2" M.I.P.
C842	48"	1/2" I.D.	SC54	1/2" F.I.P. x 1/2" M.I.P.
C844	12"	3/8" I.D.	SD54	1/2" F.I.P. x 1/2" M.I.P.
C845	18"	3/8" I.D.	SD54	1/2" F.I.P. x 1/2" M.I.P.
C846	24"	3/8" I.D.	SD54	1/2" F.I.P. x 1/2" M.I.P.
C847	30"	3/8" I.D.	SD54	1/2" F.I.P. x 1/2" M.I.P.
C848	36"	3/8" I.D.	SD54	1/2" F.I.P. x 1/2" M.I.P.

934 S.E. Sixth Avenue • Portland, Oregon 97214 • (503) 235-2167 • (800) 929-5039 • Fax (503) 239-3774

HOSE TO PIPE FITTINGS

	PART NO. C4470	DESCRIPTION 3/4 FHT x 1/2 FIP (swivel)	
	C4472	3/4 FHT x 3/4 FHT (swivel)	
	C4468	3/4 MHT x 1/2 MIP x 1/2 CWT (nominal)	
	C4460	3/4 FHT hose cap	
	C4462	1/2 MIP x 3/4 FHT	
	C4464	3/4 MHT x 3/4 MHT	

	C4471	3/4 FHT x 3/4 FIP (swivel)	
	C4467	3/4 MHT x 3/4 MIP x 1/2 FIP	
	C4469	3/4 FHT x 3/4 MIP x 1/2 FIP	
	C4461	3/4 F.I.P. x 3/4 MHT	
	C4463	1" FIP x 3/4 MHT	
	C4466	3/4 FHT x 3/4 FHT "Y" Connection	

C6957
3/4" MPT x 3/4" MPT
1 PR/Card x 3" length MIP
Dielectric Water Heater Heat Traps



Prevents escape of heat through the inlet and outlet when flow stops.

- Self-cleaning fittings prevent corrosion
- Dielectric inert thermoplastic lining
- Color coded cold inlet and hot outlet
- Meets AGA requirements
- UL approved

C480 **C481**
Dip Tubes
60" Long
Flared and Threaded

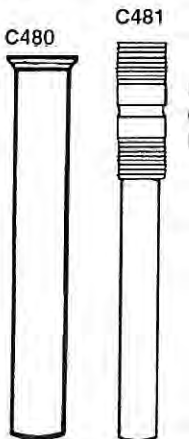

C479
3/4" MPT x 3/4" MPT
x 3" length MIP
Dielectric Nipples



For water heater inlet & outlet hook-ups plus other uses, where dissimilar metals occur in piping and plumbing systems. Thermoplastic lining prevents corrosion.

C477 Heavy Duty Element Wrench
C476 Regular Element Wrench



WATER HEATER THERMOSTATS

C464 07723 Lower APCOM

C465 07843 SGL APCOM

C466 07863 Upper APCOM

C467 08143 SGL T-O-D

C468 08123 Lower T-O-D

C469 08163 Upper T-O-D

C470 08203 Old Style Upper T-O-D

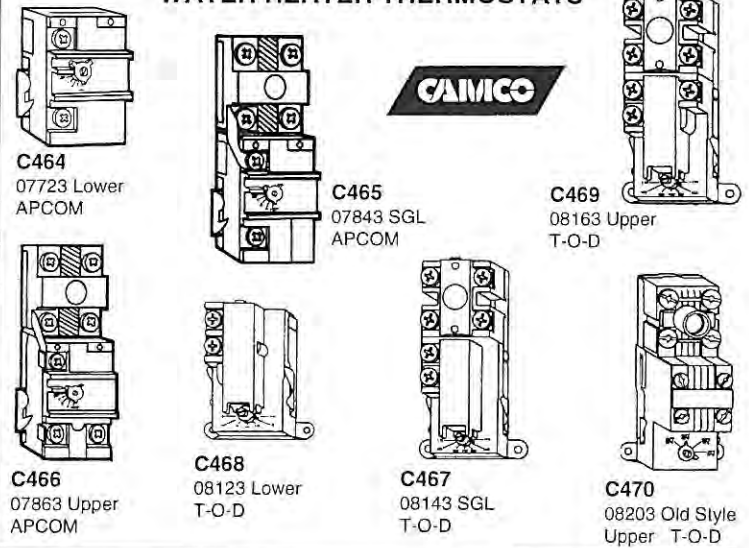

C471 - 12" **C474 - 30"**
C472 - 18" **C475 - 36"**
C473 - 24"

Universal Thermocouple Kits
Kit contains: Positioning Thermocouple adaptors to fit all gas water heaters as well as all gas appliances. Made with copper tubing.

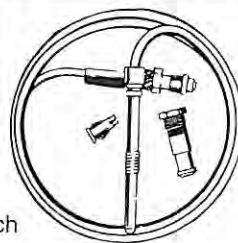

HOSE MENDERS

Don't throw away your water hoses because of leaks, holes or broken couplings. Use heavy duty polyethylene hose menders to repair any standard plastic or rubber hose.

For hose size 7/16" to 1/2"

C482 Male Coupling
C483 Female Coupling
C484 Hose Section



For hose size 5/8" to 3/4",
C485 Male Coupling
C486 Female Coupling
C487 Hose Section

Universal Adapter Kit
Converts Screw-In to replace Round Head, Flat & Universal Flange. Kit Contains:

- 1- Flat Flange
- 1- Four Hole Gasket
- 1- Round Head Gasket
- 1- Thermostat Bracket
- 4- 1/2" Self Tapping Screws

Stock # 07223 **C463**

